

LAND "A" & C - Allotted by DDA with Land use "Multi Level Parking"

LAND "B" - NORTH DMC Land (Land use to be changed as "Multi Level Parking")

DELHI DEVELOPMENT AUTHORITY
AREA PLANNING
ZONE-A
(OTHER THAN WALLED CITY)



NOTE:
1. THIS DRAWING HAS BEEN TRACED FROM THE PT SURVEY SUPPLIED BY THE SURVEY UNIT OF PLANNING DEPARTMENT, DDA DATED 02.10.2018 ONLY WRITTEN DIMENSIONS TO BE FOLLOWED.
2. TENTATIVE BOUNDARY OF PLOTS A, B, C AS PER MCD PLAN HAS BEEN EXAMINED IN 2018.

- AREA STATEMENT
- TOTAL AREA OF OLD SLAUGHTER HOUSE (SHAH BHARGAN) NEAR MCD PLAND & B. C.D.A. (1950-55) 12350 SQ.M. = 4500 SQ. YDS (29 HA)
 - SITE CARVED OUT FOR SECONDARY SCHOOL FROM PLOT 'A' 1600 SQ.M (250 M X 250 M)
 - THE APPLICABILITY OF DEVELOPMENT CONTROL NORMS SHALL BE AS PER MCD-200 PROVISIONS.
 - THE POKETS MENTIONED AS A, B, C ARE NOTIONAL AND ARE AS PER THE PLAN SUBMITTED BY M.C.D. (MCD-200). DDA HAS ALSO VERIFIED THAT POKETS 'A', 'B' & 'C' ARE DDA LAND & POKET 'B' IS WITH M.C.D.
 - BEFORE DEMARCATION/ALLOTMENT OF THE PROPOSED SCHOOL PLOT, ENCROACHMENT OF 13.5M WIDE ROAD SHOWN IN THE MCD PLAN IS TO BE VERIFIED BY I.A.M.WING, DDA BEFORE ALLOTMENT.

DELHI DEVELOPMENT AUTHORITY
FIELD CO-ORDINATION UNIT
VERIFIED
ALL DIMENSIONS AND COORDINATES TO BE FOLLOWED
Date: 07/12/2018
Dr. Omkar Prasad

DELHI DEVELOPMENT AUTHORITY
CER
Approved by: [Signature]
Civil Engineer (S) on 27.11.18
Date: 07/12/2018
Name: [Signature]
District Engineer (S)

UTILIZATION PLAN OF PART OF LAND AT OLD SLAUGHTER HOUSE NEAR SHAH BHAGAN, BHARGAN, DELHI PLANNING ZONE-A (OTHER THAN WALLED CITY) FOR CARVING OUT A SECONDARY SCHOOL SITE (1600 SQM) ON THE REQUEST OF DIRECTORATE OF EDUCATION, GNCTD FOR ALLOTMENT TO QAIMI EDUCATION SOCIETY.

NOT TO SCALE

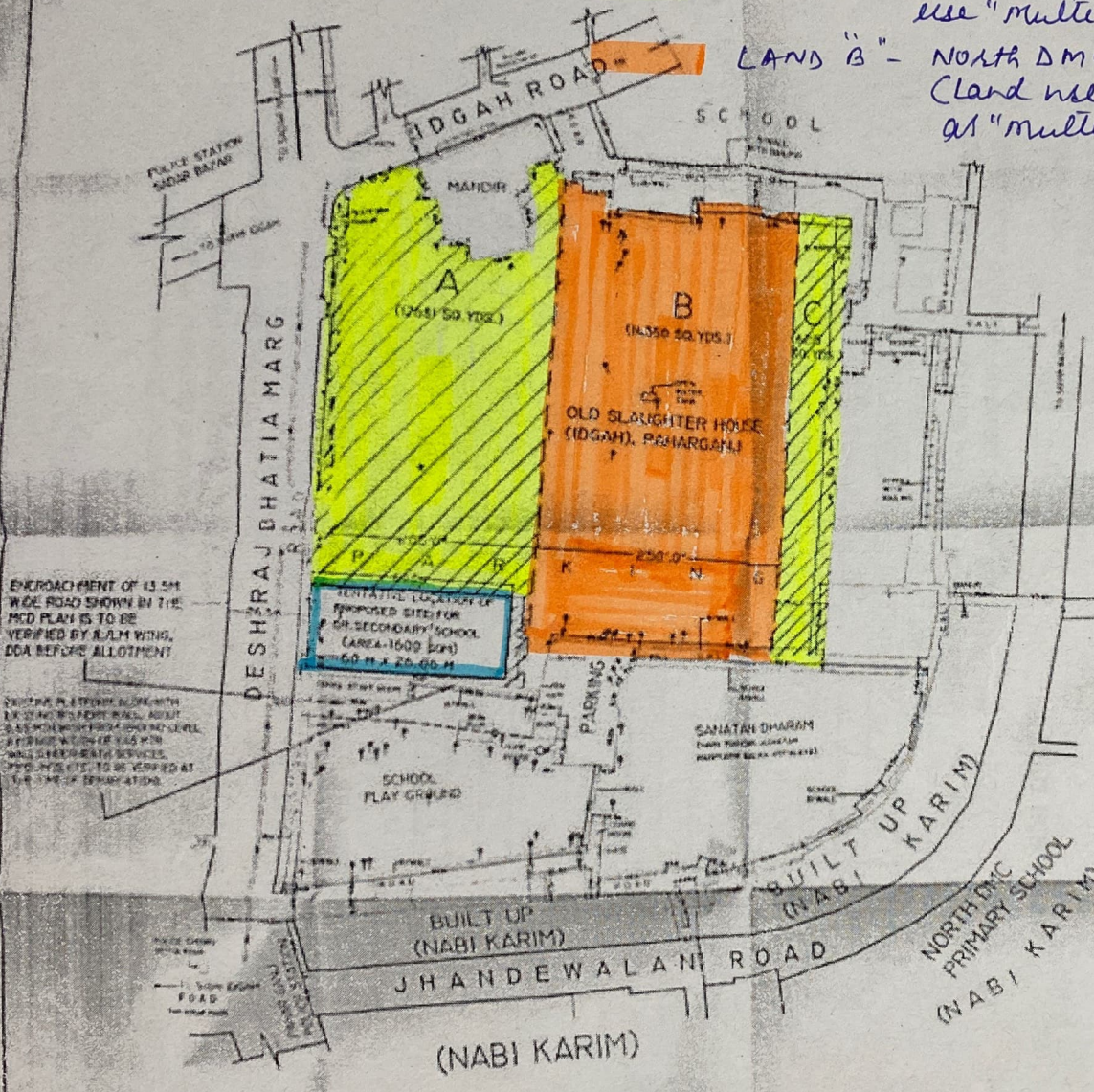

ENCROACHMENT OF 13.5M WIDE ROAD SHOWN IN THE MCD PLAN IS TO BE VERIFIED BY I.A.M.WING, DDA BEFORE ALLOTMENT

CENTRAL PLASTERING SLAB WITH 12.5% SLOPE FOR DRAINAGE, ABOUT 2.5% SLOPE FOR 100% COVER LEVEL, PAVEMENT COVER 145 MM W/LL SHEEDERITE SERVICES, PROPOSED TO BE VERIFIED AT THE TIME OF DEMARCATION.

As per letter no. FAD(48)17/21/2018 dated 30.01.2019 by land management 14193-4620m (A&C except 1000 sqm in school)

Handed over (Sachin Kumar) 40/10/2018 DDA

[Signature]
Tarek Mehta
Sachin Kumar
Sachin Kumar

20/11/18